

### GGM CAMS06



The **GGM CAMS06** is a professional 1-CH video server for remote surveillance. Embedded with VVTK-1000 SoC, it not only provides dual-codec video compression in MPEG-4 and MJPEG formats to efficiently optimize image quality and bandwidth, but also can simultaneously deliver dual streams with different resolutions up to D1 and video quality upon separate devices. Users can easily migrate to an IP-based digital open system from the existing analog close system and meet different requirements for live viewing and recording.

**GGM CAMS06** also comes with versatile functions to meet specific applications such as 3GPP mobile surveillance, digital I/O for external sensor and alarm, RS-485 interface for PTZ camera control, and privacy masks and so on. This video server provides a cost-effective solution for a transit from CCTV to IP video.

#### PRODUCT ASSETS

- MJPEG** Dual codec  
**MPEG-4** MJPEG/MPEG-4
-  Full D1 résolution  
at 25 FPS
-  Privacy mask
-  Motion detection

#### PRODUCT FEATURES

- Real-time MPEG-4 and MJPEG compression (dual codec)
- Up to 30 fps in D1 Resolution
- Supports Dual Streams Simultaneously
- 3GPP Mobile Surveillance
- Two-way Audio by SIP Protocol
- Digital I/O for External Sensor and Alarm
- RS-485 Interface for Scanners, Pan/Tilts
- Privacy Masks

# GIGAMEDIA

## PROFESSIONNEL

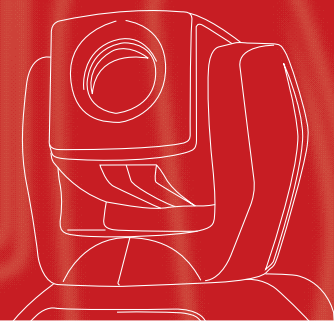

### PRODUCT SPECIFICATION

### GGM CAM506

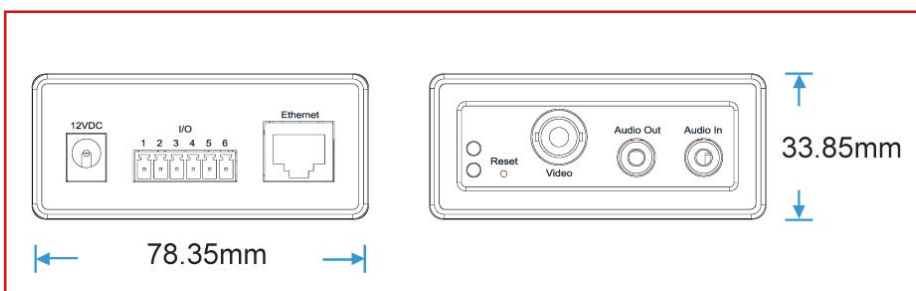

#### WEIGHT

Net 198 g

#### LED INDICATOR

System activity and network link indicator

#### POWER

12V DC  
Power consumption: Max. 4 W

#### APPROVALS

CE, LVD, FCC, VCCI

#### OPERATING ENVIRONMENTS

Temperature 0 ~ 50 °C (32 ~ 122 °F)  
Humidity 20% ~ 80% RH

#### VIEWING SYSTEM REQUIREMENTS

OS Microsoft Windows 2000/XP/Vista  
Browser Internet Explorer 6 or above  
Cell phone 3GPP player  
Real Player 10.5 or above  
Quick Time 6.5 or above

#### INSTALLATION, MANAGEMENT & MAINTENANCE

Installation Wizard 2  
Supports firmware upgrade

#### APPLICATIONS

SDK available for application development and system integration

#### WARRANTY

24 months

#### SYSTEM

CPU VVTK-1000Soc  
Flash 8Mb  
RAM 64Mb  
Embedded OS Linux 2.4

#### VIDEO

Compression MJPEG & MPEG-4  
Streaming Simultaneously dual-streaming  
MPEG-4 streaming over UDP, TCP or HTTP  
MPEG-4 multicast streaming  
MJPEG streaming over HTTP  
Supports 3GPP mobile surveillance  
Frame rates MPEG-4 :  
Up to 30/25 fps at 176x112/176x144  
Up to 30/25 fps at 352x240/352x288  
Up to 17 fps at 704x480/704x576  
MJPEG :  
Up to 30/25 fps at 176x112/176x144  
Up to 30/25 fps at 352x240/352x288  
Up to 12 fps at 704x480/704x576

#### AUDIO

Compression GSM-AMR speech compression, bit rate :  
4.75 kbps ~ 12.2 kbps  
MPEG-4 AAC audio encoding, bit rate :  
16 kbps ~ 128 kbps  
Interface Line level in/out: up to 1 Vrms  
Audio output  
Supports two-way audio by SIP protocol  
Supports audio mute

#### PAN/TILT/ZOOM

PTZ Camera control through RS-485  
Supported devices and protocols:  
DynaDome/SmartDome  
Pelco D  
LiLin  
Supports CGI command serial driver

#### NETWORKING

10/100 Mbps Ethernet, RJ-45  
Protocols IPv4, TCP/IP, HTTP, UPnP, RTSP/RTP/RTCP,  
IGMP, SMTP, FTP, DHCP, NTP, DNS, DDNS and PPPoE

#### ALARM AND EVENT MANAGEMENT

Triple-window video for motion detection  
One D/I and one D/O for external sensor and alarm  
Event notification using HTTP, SMTP or FTP

#### SECURITY

Multi-level user access with password protection  
IP address filtering

#### UTILISATEURS

Live viewing for up to 10 clients

#### DIMENSIONS

130 mm (D) x 78.35 mm (W) x 33.85 mm (H)

#### VOTRE INTERLOCUTEUR CONSEIL

