



**1,3 MEGAPIXEL DC IRIS**  
IR CORRECTED  
GGM CC1V5100DIR



**1.3 MP**  
1,3 MEGAPIXEL

**IR**  
IR CORRECTED

**IRIS DC**  
IRIS DC

**PRODUCT SPECIFICATION**

<b>DESIGNATION</b>	DC iris / 1,3 Megapixel / IR corrected	<b>MOUNT</b>	CS	<b>WEIGHT</b>	164 g ±5%
<b>MODEL NO</b>	GGM CC1V5100DIR	<b>FORMAT (INCH)</b>	1/3"	<b>M.O.D (MINIMUM OBJECT DISTANCE)</b>	0.7 m
<b>FOCAL-LENGTH</b>	5 - 100 mm	<b>HORIZONTAL FIELD H/V</b>	52° - 2.8°	<b>OPERATION</b>	Focus (w/lock) Zoom (w/lock) Iris DC
<b>APERTURE (D/F')</b>	1/1.6	<b>DIMENSION</b>	Diameter 37.5 x 87.4 x 57.4 mm		

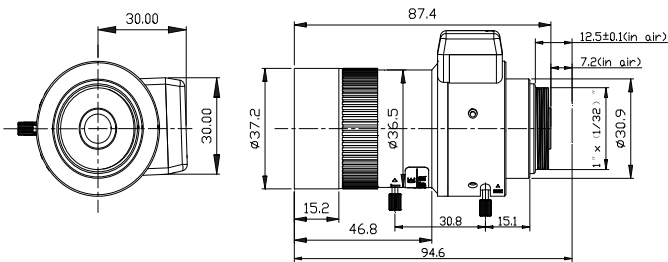

Auto-Iris		
	<b>DC Resistance</b>	Excite 200Ω ±10% Brake 560Ω ±10%
	<b>Operating Voltage</b>	C O 3.5V~5V
<b>Iris Wiring instruction</b>	①	Drive-
	②	Drive+
	③	Damp
	④	Damp
Iris Line Length:300mm		
<b>Lens Operational Environment</b>	<b>Storage Environment</b>	<b>Working Environment</b>
	-20 ~+60 ; 10~90%RH (non-condensing)	-10 ~+50 ; 10~90%RH (non-condensing)

YOUR POINT OF CONTACT

